

## How to bypass the Microwave Sensor for standard 0-10V dimming applications.

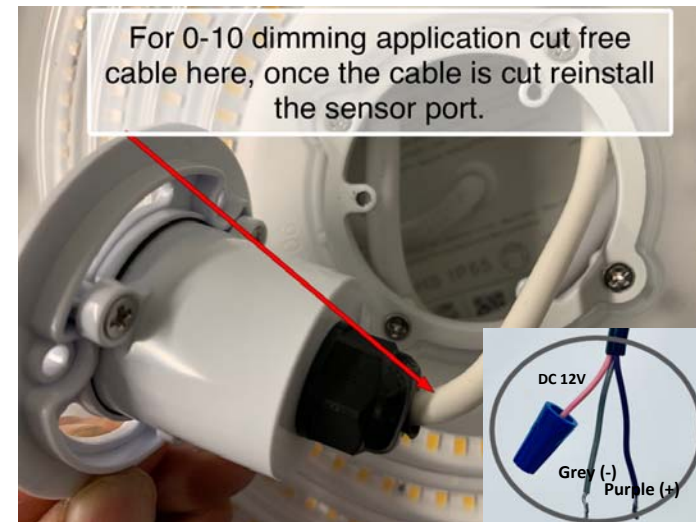

Optional Whip connector 65/169 (BLK) 65/170 (WHT)  
5.5 foot; IP68 Rated 0-10V Dimming

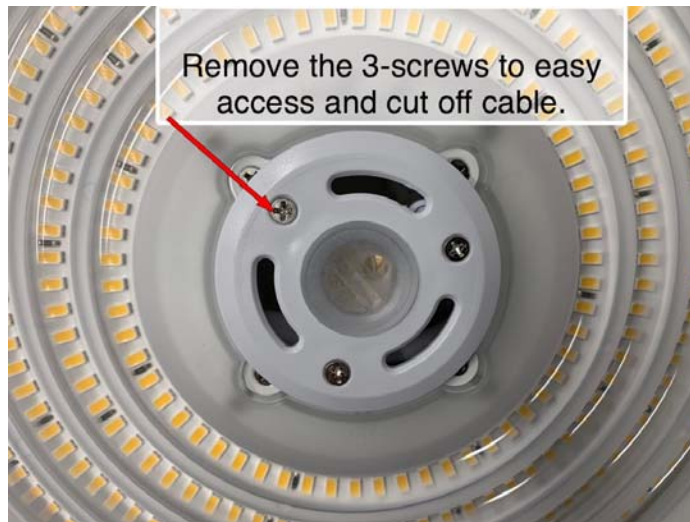

The LED high bay light can be equipped with an optional DC motion sensor (86/218). The sensor needs to be set via remote (86/219). **For standard 0-10V dimming applications, the dimming cable must be cut free from the integrated DC sensor port.**

