

HD406VRH

Dimmable version



On/off control



Stand-by
dimming level



Detection area



Remote control
setting



Hold time

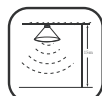

10-15M Highbay
altitude



Daylight threshold



Stand-by period



warranty
5
years

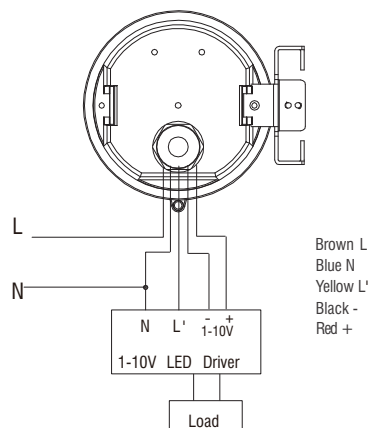

01 Technical data

Operating voltage	120-277VAC, 50Hz/60Hz
Switching capacity	Max, 3.0A@120Vac, 50/60Hz; Max, 2.0A@277Vac, 50/60Hz
Stand-by power	<1W
Detection area	25%/50%/75%/100%
Hold time	5s/30s/1min/3min/5min/10min/20min/30min
Daylight threshold	2Lux/10Lux/30Lux/50Lux 80Lux/120Lux/Disable
Stand-by period	0s/10s/30s/1min/5min/10min/30min/+∞
Stand-by dimming level	10%/20%/30%/50%
Microwave frequency	5.8GHz±75MHz
Microwave power	<1mW
Mounting height	Max. 15m
Detection range	Max. Ø14m
Control line	Brown L, Blue N, Yellow L', Black -, Red +
Operating temperature	-35°C ~ +60°C
IP rating	IP65
Detection angle	30°-150°
Safety standard	EN61347-1 EN61347-2-13 EN60598-1

Note: Motion sensor setting and dimming setting please refer to remote control HD02R/HD03R.

02 Mechanical structure(mm)

HD406VRH (A)

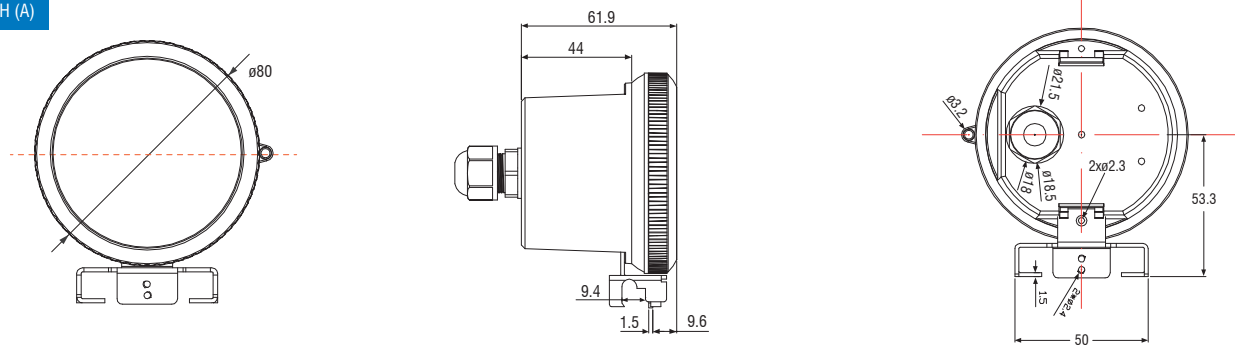

HD406VRH (B)

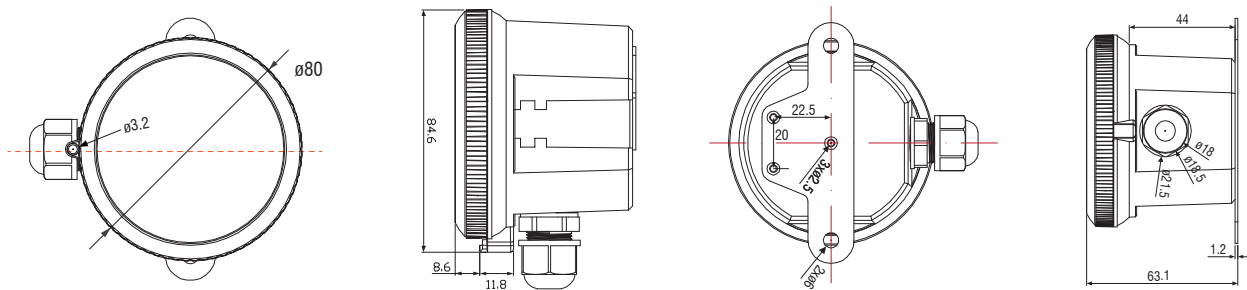

HD406VRH (C)

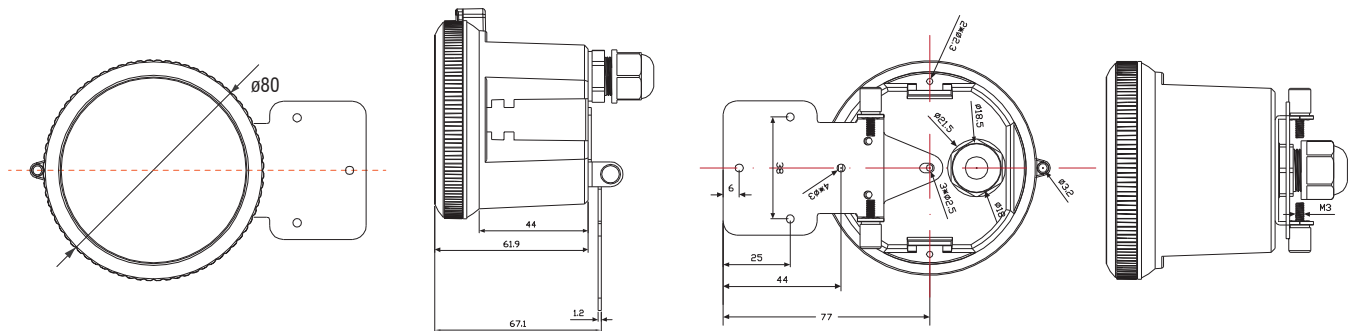

HD406VRH (D)

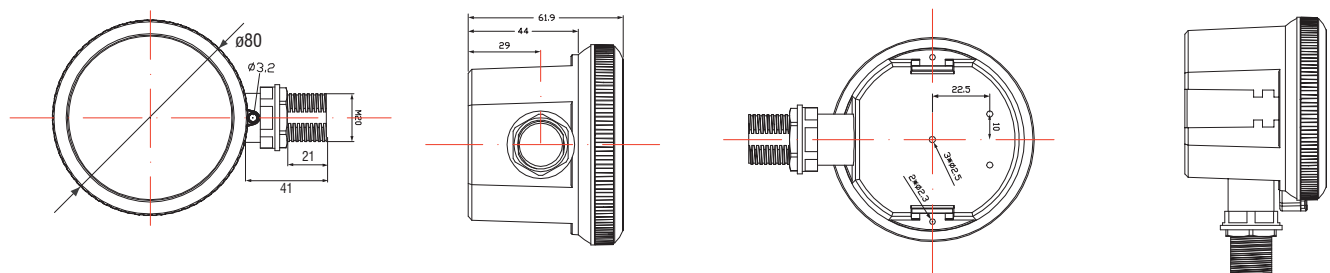

03 Installation Method

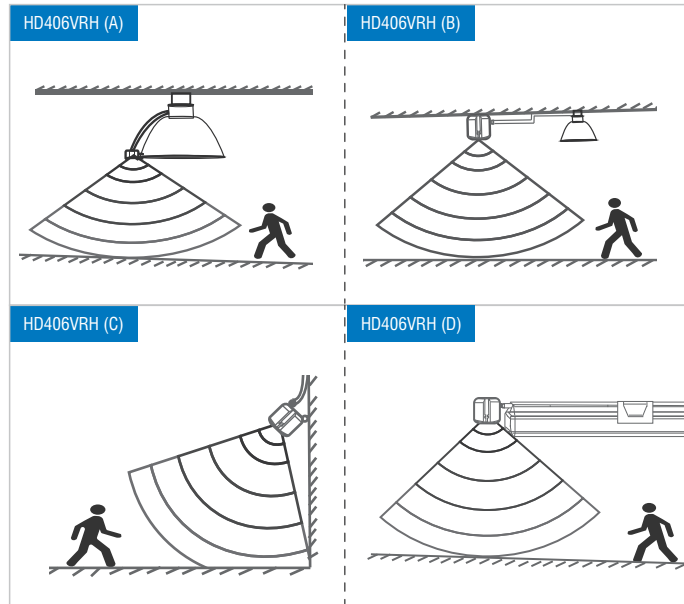

04 Detection coverage

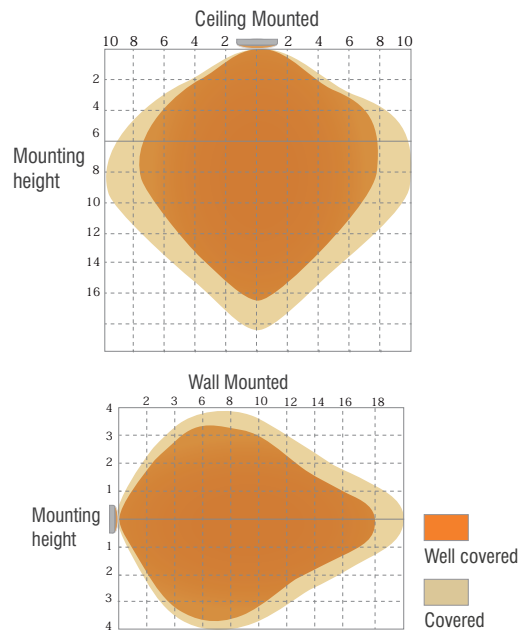

05 Settings

Pin	Setting
1	100%
2	75%
3	5s
4	30s
5	1min
6	5min
7	10min
8	20min
9	30min
10	Disable
11	120Lux
12	80Lux
	50Lux
	30Lux
	10Lux
	2Lux
	0s
	10s
	30s
	1min
	5min
	30min
	+∞
	10%
	20%
	30%
	50%

Detection area
Detection area means detection coverage. It can be adjusted by combining DIP switches for specific application.

Hold-time
Hold-time means the time period the light will be ON after the last detection.

Daylight threshold
Daylight sensor prior to motion sensor. Set threshold for specific needs. If Disable, only motion sensor works.

Stand-by period
This is the time period the light keeps dimming down after the last detection.

Stand-by dimming level
This is the dimming level the light keeps during standby period.

06 Application

Function Demo - Dimmable control/Corridor function



With sufficient daylight, even when motion detected, light remains OFF.



With insufficient daylight, when motion detected, light ON.

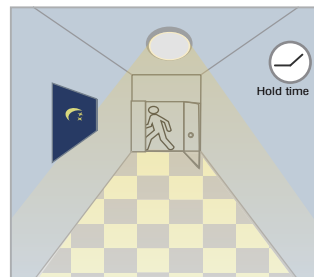

After last detection, the light will be dimmed down to the stand-by dimming level (10%, 20%, 30% or 50%) after holdtime.

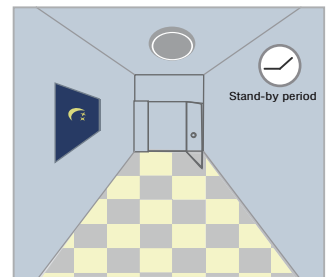

After the stand-by period, light OFF.