

# 290\*210mm

## **SATCO**® Downlight Retrofit Series Installation Instructions

### IMPORTANT

READ INSTRUCTIONS CAREFULLY BEFORE INSTALLING. KEEP THESE INSTRUCTIONS FOR FUTURE REFERENCE.

SATCO fixtures must be wired in accordance with the National Electrical Code and all applicable local codes. Proper grounding is required for safety. THIS PRODUCT MUST BE INSTALLED IN ACCORDANCE WITH THE APPLICABLE INSTALLATION CODE BY A QUALIFIED ELECTRICIAN WHO IS FAMILIAR WITH THE CONSTRUCTION AND OPERATION OF THE PRODUCT AND THE HAZARD INVOLVED.

**WARNING** - Risk of fire or electric shock. Downlight Retrofit Series installation requires knowledge of the luminaires' electrical systems. If not qualified, DO NOT attempt installation. Contact a qualified electrician.

**WARNING** - Risk of fire or electric shock. Install this kit only in the luminaires that have the construction features and dimensions shown in the photographs and/or drawings, and where the input rating of the retrofit kit does not exceed the input rating of the luminaire. DO NOT make or alter any open holes in an enclosure of wiring or electrical components during kit installation.

**WARNING** - To prevent wiring damage or abrasion, DO NOT expose wiring to edges of sheet metal or other sharp objects.

**WARNING** - This device is not intended for use with emergency exits.

**AVERTISSEMENT** - RISQUE D'INCENDIE OU DE CHOC ÉLECTRIQUE. L'INSTALLATION DE CE NÉCESSAIRE DE MODERNISATION EXIGE UNE PERSONNE FAMILIÈRE AVEC LA CONSTRUCTION ET LE FONCTIONNEMENT DU SYSTÈME ÉLECTRIQUE DU LUMINAIRE ET DES RISQUES ASSOCIÉS. TOUTE PERSONNE QUI N'EST PAS QUALIFIÉE NE DOIT FAIRE AUCUNE TENTATIVE D'INSTALLATION ET DOIT CONTACTER UNE PERSONNE QUALIFIÉE.

**AVERTISSEMENT** - RISQUE D'INCENDIE OU DE CHOC ÉLECTRIQUE. N'INSTALLER CE NÉCESSAIRE QUE DANS LES LUMINAIRES DONT LES CARACTÉRISTIQUES DE CONSTRUCTION ET LES DIMENSIONS SONT CONFORME À CELLES ILLUSTRÉES DANS LES PHOTOS ET/OU LES DESSINS ET DONT LA PUISSANCE D'ENTRÉE NOMINALE DU NÉCESSAIRE DE MODERNISATION NE DÉPASSE PAS CELLE DU LUMINAIRE. IL EST INTERDIT DE FAIRE OU DE MODIFIER UNE OUVERTURE DANS UN BOÎTIER DE CÂBLAGE OU DE COMPOSANTS ÉLECTRIQUES AU COURS DE L'INSTALLATION DU NÉCESSAIRE.

**AVERTISSEMENT** - AFIN DE PRÉVENIR L'ENDOMMAGEMENT OU L'ABRASION DES CÂBLES, ÉVITER TOUT CONTACT ENTRE CES DERNIERS ET LE BORD D'UN OBJET TRANCHANT TEL QU'UNE TÔLE.

**AVERTISSEMENT** - NE CONVIENT PAS AUX SORTIES DE SECOURS.

### Warranty Information:

This product is warranted for 5 years from the date of purchase, based on 12 hours of use per day. If this product does not perform to the specifications noted on this package, visit [www.satco.com/warranty-information](http://www.satco.com/warranty-information) for instructions. Liability for incidental or consequential damage is expressly excluded. Visit [www.satco.com](http://www.satco.com) for full warranty details and dimmer compatibility information.

### Product Size:

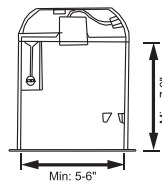
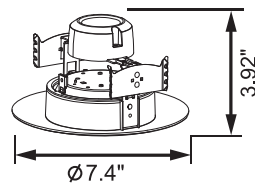

### Installation steps:

1

TURN OFF THE POWER PRIOR TO INSTALLATION. Remove the diffuser and existing bulb if necessary. Remove the existing trim.

2

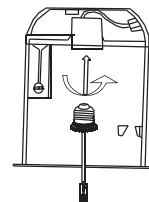

Twist the lamp base into the lamp holder.

### Installation steps:

3

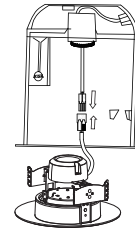

Connect the quick disconnect between the retrofit kit and the medium base umbilical socket.

4

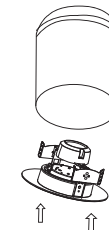

Position the spring clips into the metal mounting clips on the inside of the housing.

5

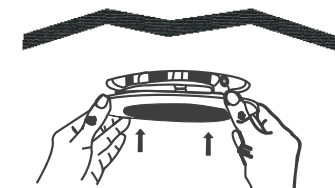

Push the LED retrofit trim into the recessed light fixture. Continue to push the LED trim until its outer edge is flush with the ceiling surface.

### Use steps:

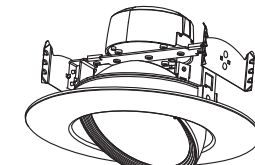
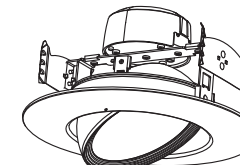
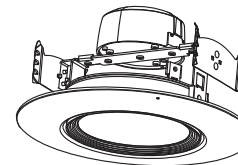

Press up on one side until the other side shifts out then twist it to the desired angle.

[www.satco.com](http://www.satco.com)

Satco Products, Inc.  
110 Heartland Blvd.  
Brentwood, NY 11717