

LED Flat panel fixtures

Even, consistent light.
Low maintenance.
High efficiency.

Applications / Features

- DLC 4.0 certified
- Maintenance free—no bulb to change
- Perfect, even light distribution
- CRI > 90
- Ultra-slim edge-lit design
- Lasts 50,000 hours of continuous use
- 0-10V dimming
- Universal input voltage—100-277V
- 3500K, 4000K and 5000K versions
- Suspended* or drop into T-bar grid
- Certified for damp locations
- 5 year warranty

PRODUCT INFORMATION

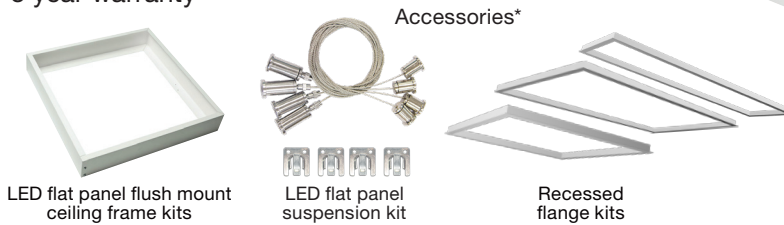

LED Flat Panel



Item Number	Lamp Description	W	Voltage	CRI	CCT	Lm	Efficiency (LM/W)	Life/ Hrs.	UPC	Pack
65/311	2FT X 2FT LED FLAT PANEL 37 WATT	37	100-277	90	3500K	3800	103	50K	045923643118	2
65/312	2FT X 2FT LED FLAT PANEL 37 WATT	37	100-277	90	4000K	3880	105	50K	045923643125	2
65/313	2FT X 2FT LED FLAT PANEL 37 WATT	37	100-277	90	5000K	3960	107	50K	045923643132	2
65/314	1FT X 4FT LED FLAT PANEL 37 WATT	37	100-277	90	3500K	3800	100	50K	045923643149	2
65/315	1FT X 4FT LED FLAT PANEL 37 WATT	37	100-277	90	4000K	3880	100	50K	045923643156	2
65/316	1FT X 4FT LED FLAT PANEL 37 WATT	37	100-277	90	5000K	3960	100	50K	045923643163	2
65/317	2FT X 4FT LED FLAT PANEL 48 WATT	48	100-277	90	3500K	5000	104	50K	045923643170	2
65/318	2FT X 4FT LED FLAT PANEL 48 WATT	48	100-277	90	4000K	5070	105	50K	045923643187	2
65/319	2FT X 4FT LED FLAT PANEL 48 WATT	48	100-277	90	5000K	5140	107	50K	045923643194	2

Accessories					
Item Number	Description	Dimensions	Finish	UPC	Pack**
65-361	1FT x 4FT LED FLAT PANEL FRAME KIT	47 5/8" L x 11 5/8" W x 3" D	White	045923673610	10/1
65-362	2FT x 2FT LED FLAT PANEL FRAME KIT	23 5/8" L x 23 5/8" W x 3" D	White	045923663628	10/1
65-363	2FT x 4FT LED FLAT PANEL FRAME KIT	47 5/8" L x 23 5/8" W x 3" D	White	045923663635	10/1
65-367	FLAT PANEL SUSPENSION KIT	48" Cable	Steel	045923653674	100/1
65-364	1FT x 4FT RECESSED FLANGE KIT	49" L x 13" W x 1 1/2" D	White	045923673641	10/1
65-365	2FT x 2FT RECESSED FLANGE KIT	25 1/2" L x 25" W x 1 1/2" D	White	045923663598	10/1
65-366	2FT x 4FT RECESSED FLANGE KIT	49" L x 25" W x 1 1/2" D	White	045923653667	10/1

* All accessories sold separately. ** Sold in 2 packs only. † Go to www.satco.com for complete warranty information.

Specifications

ITEM	SPECIFICATION	DETAILS
General Performance	Efficacy (LM/W)	100lm/w
	CRI	>90
	Color Consistency	Proprietary binning for uniform color
	Lumen Maint. (L70)	50,000 hours
Electrical	Power Factor	Over 95%
	Input Voltage	100V-277V 50/60 Hz
	Power Consumption	40&50 Watt nominal
Control	Dimming Switch	Standard 0-10V dimming 10%-100%
	Linking Lengths/Qty.	15 Cable Feet x 20 Panels
Physical	Dimensions	23.7" x 47.6" x 1.8"
	Weight: 2' x 4'	28.25 lbs.
	Weight: 2' x 2', 1' x 4'	8.8 lbs.
	Housing	Aluminum
	Lens	Translucent white PS
	Mounting	Fits standard grid for drop ceilings
	Operating Temperature	-5°F to 104°F
	Humidity	20% - 85% RH, non condensing
Certification	Certification	cETLus, DLC, Fcc
	Material Usage	RoHS compliant; no mercury
	Environment	Damp location
	Warranty	Five year

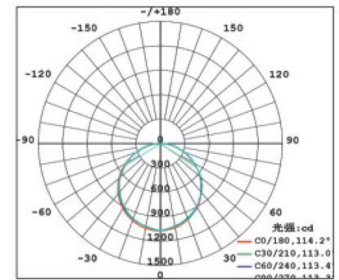
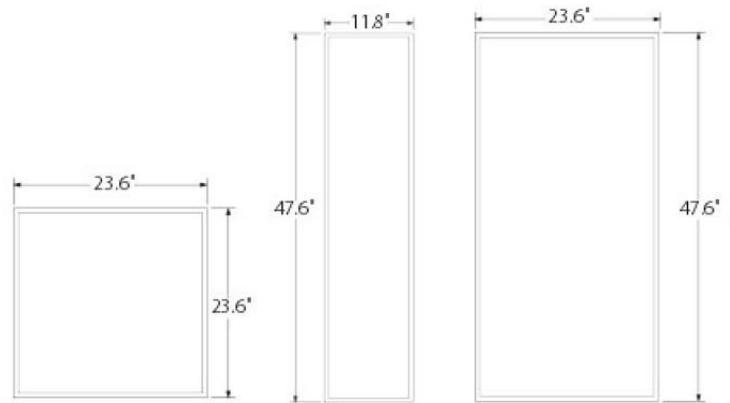

0-10V Dimmer Compatibility

Brand	Description	Model	Load Max	Poles	Performance Rating
Lutron	Diva 0-10V control (gloss finish), single pole, preset, 30mA sink, 16A load (needs Power Pack PP-DV)	DVTV (DIVA)	120-277 30mA/16A	Single	Best
Lutron	Diva 0-10V control (gloss finish), single pole/3-way, preset, 50mA sink, 8A load	DVSTV (DIVA)	120-277 50mA/8A	Single pole/3-way	Best
Lutron	Diva 0-10V control (satin finish), single pole, preset, 30mA sink, 16A load (needs Power Pack PP-DV)	DVSCTV (DIVA)	120-277 30mA/16A	Single	Best
Lutron	Diva 0-10V control (Satin finish), single pole/3-way, preset, 50mA sink, 8A load	DVSCSTV (DIVA)	120-277 50mA/8A	Single pole/3-way	Best
Lutron	Maestro 0-10V Dimmer and Occupancy/Vacancy PIR Sensor, single pole/multi location	MSZ101-WH	120-277 V ^8A	Single pole/Multi	Better
Cooper	Dimmable LED/FLR0-10V ballasts, DEVINE Slide Dimmer, single pole/3-way, preset	DF10P	1200W 120V/60Hz 1600W 277V/60Hz	Single pole/3-way	Better
Cooper	Dimmable LED/FLR0-10V ballasts, SKYE Slide Dimmer, single pole/3-way, preset	SF10P	1200W 120V/60Hz 1600W 277V/60Hz	Single pole/3-way	Better
Leviton	Designed for use with LED fixtures Using 0-10V power supplier, No power pack req. for switching	DS710-10Z	120VAC/60Hz 277VAC/60Hz	Single pole/3-way	Best
Leviton	LED Dimmer for 0-10V power suppliers, no LED locator	IP710-LFZ	1200VA@120VAC 1500VA@277VAC	Single/2Gang/ 3-Gang	Best
Lutron	Lutron Maestro 0-10V Dimmer and Vacancy PIR Sensor, single pole/multi-location, 120-277V, Capacity 8A	MS-Z101V (Maestro)	120-277 V Capacity 8A. 50mA	Single pole/3-way	Best
Lutron	Lutron NovaT 0-10 V Dimmer Single pole (small control), line voltage - no power pack required, 0-10 V / 30 mA / 8 A	NTSTV-DV (Nova T)	120-277 V Capacity 8A. 30mA	Single pole	Best