

## TECHNICAL INFORMATION

### LED strip fixtures

**Linkable & non-linkable  
(stand-alone) series, models  
65-1101, 65-1102, 65-1103, 65-1104**

LED strip lighting series with integrated driver stand-alone strip light or connectible strips. Models include a 4' stand-alone strip and 1', 2' and 4' connectible strips.

#### Specifications

- Even consistent light distribution
- Maintenance free—no bulb to change
- Ultra-slim design

#### Applications

- Surface mount on ceiling or wall
- Approved for damp locations
- Direct wire or power cord
- Connectible strips, 5 max.

#### LED light engine

- 4' Standalone module at 24 Watts/4000K/90 CRI delivering 1800 lumens
- 1' Connectible module at 12 Watts/4000K/90 CRI delivering 840 lumens
- 2' Connectible module at 24 Watts/4000K/90 CRI delivering 1680 lumens
- 4' Connectible module at 36 Watts/4000K/90 CRI delivering 2600 lumens

#### Mounting

- Simple screw mount through fixture body using mounting holes

#### Housing

- Steel channel body with direct-wire knockouts and mounting holes
- Polycarbonate lens
- Integrated plastic end cap female connectors

#### Accessories

- Model 65-1107 5' power cord
- Model 65-1108 8" connector for linkable fixtures

#### Warranty/listings

- 5 Year warranty
- cETLus listed
- ENERGY STAR certified

Product detail (PU form OM)

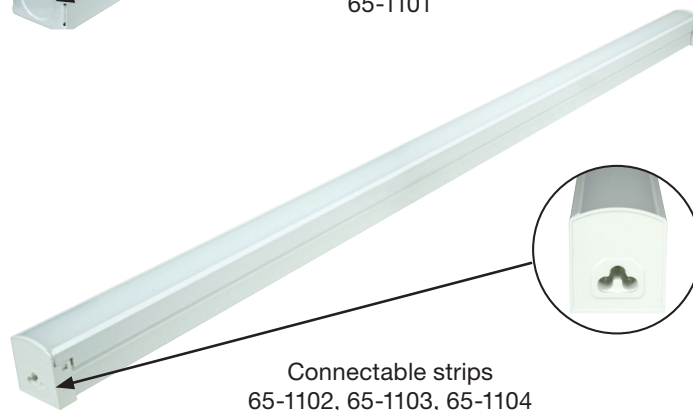
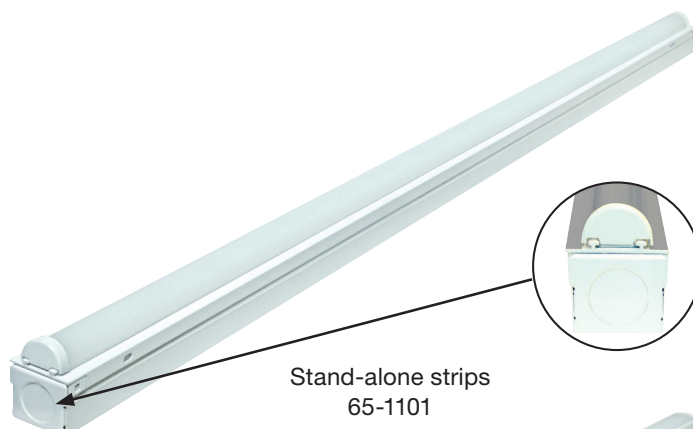

#### Accessories



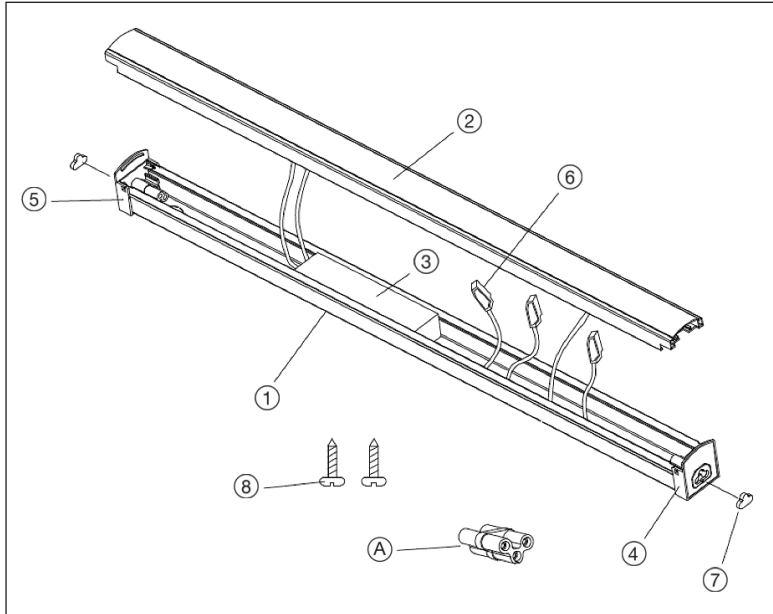

## ASSEMBLY PART LIST

Part	Description	Quantity
1	Housing assembly	1
2	LED Cover assembly	1
3	LED Driver	1
4	"Keyed" connector port	1
5	Standard connector port	1
6	Push-in wire connector	3
7	Port cover	2
8	Mounting screw	2
A	Row connector	1

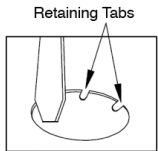

Figure 1

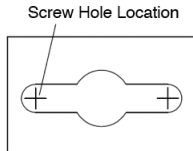

Figure 2

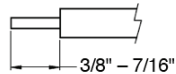

Figure 3



Figure 4

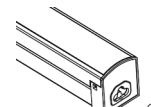

Figure 5

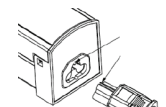

Figure 6



Figure 7

## LED Strip Fixtures



Item Number	Size	Watt	Input Voltage (V)	CCT	Lumens	CRI (RA)	PF	Location	Life/ Hrs.	Installation	Linkable or Non
65-1101	4FT	24	100-277	4000K	1800	90	0.9	Damp	50K	surface mounting on ceiling or wall	Non Linkable
65-1102	1FT	12	120	4000K	840	90	0.9	Damp	50K	surface mounting on ceiling or wall	Linkable
65-1103	2FT	24	120	4000K	1680	90	0.9	Damp	50K	surface mounting on ceiling or wall	Linkable
65-1104	4FT	36	120	4000K	2600	90	0.9	Damp	50K	surface mounting on ceiling or wall	Linkable