

SMART WIRELESS VIDEO DOORBELL WITH REMOTE CHIME



COMPLETE DOORBELL SYSTEM

**SIMPLE WIRELESS
INSTALLATION**

RECHARGEABLE BATTERY

**REMOTE VIEWING AND
TWO-WAY TALK**

**LIVE AND EVENT HISTORY
MONITORING**

**EXPANDABLE MICRO SD CARD
STORAGE**

**ADDITIONAL CHIMES
AVAILABLE**



STARFISH
live life enlightened

Easily expand home security with SATCO|NUVO's Smart Wireless Doorbell with Remote Chime. This complete doorbell system comes with rechargeable battery so that the unit can be installed with no electrical work. Motion detection sends alerts directly to your mobile device allowing you to view historical events and live events in real time, from anywhere. The included chime plugs into standard 120V outlets, making the doorbell audible, even if your mobile is on silent.

These doorbells are also compatible with Google Home, Siri, SmartThings, and Alexa, including the Alexa Show.

**NO MONTHLY
SUBSCRIPTION**

**WET
LOCATION**

**IP
65**

**1 YEAR
WARRANTY**

**TRUSTED
NB**

**BATTERY
OPERATED**

STARFISH' ENABLED PRODUCT



Night Vision



Remote Access



Multi-User



AWS Secure

WIFI
2.4GHz
No Hub Required

works with
Google Home

works with
alexa

Add to Siri

Works with
SmartThings

GENERAL SPECIFICATIONS

Input Voltage, Frequency: WiFi: 2.4GHz

Camera Resolution: 1080p

Field of View: 140° Diagonal

Local Storage:

32GB SD Card Included (Expandable up to 128GB)

Battery Type: 5000mAh Rechargeable

Rechargeable Battery:

Lasts 4-6 Months with Average 10 Daily Activations

Operating Temperature: -20°C (-4°F) to +45°C (+113°F)

Location Rating: IP65 Rated for use in Wet Locations

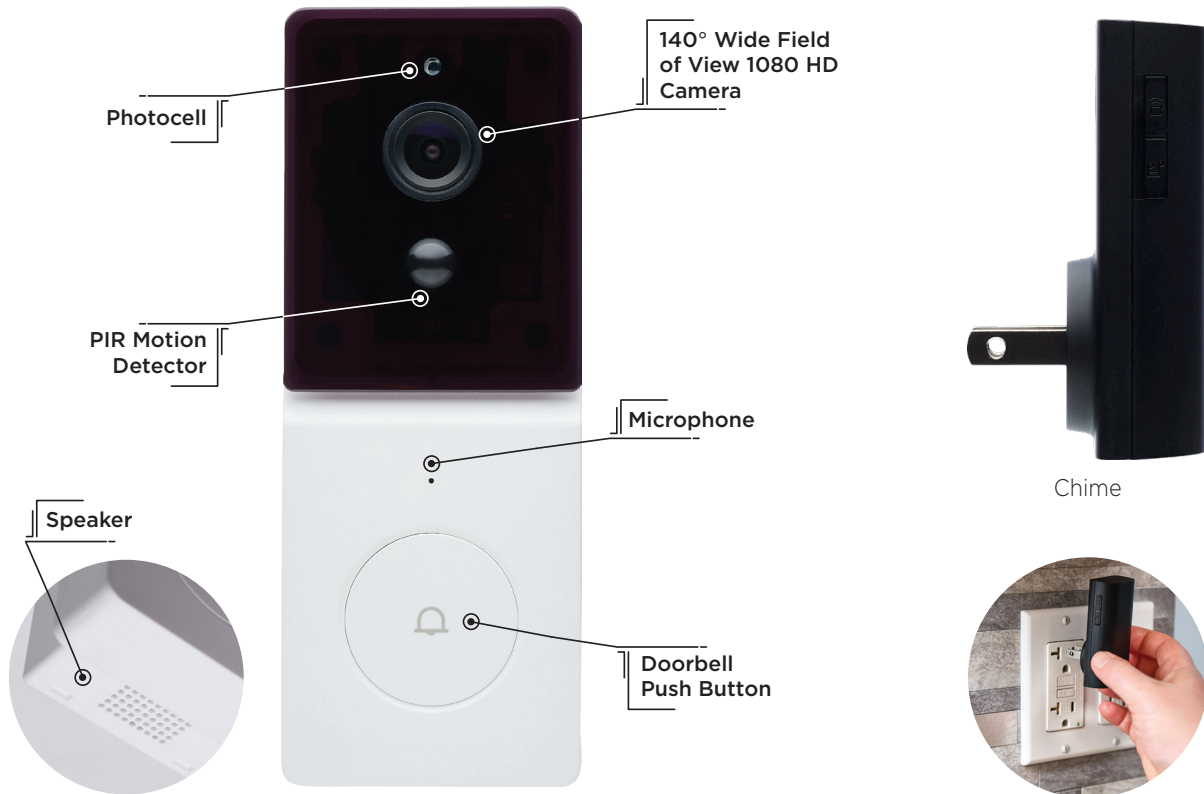

DOWNLOAD THE
STARFISH APP



CONNECT

Download the STARFISH® app

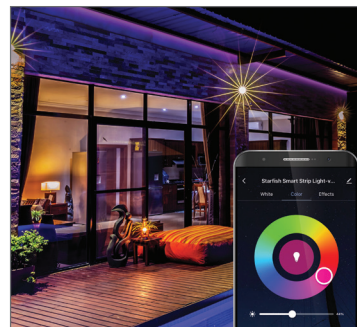

INSTALL

Pair and configure your
settings



ENJOY

The convenience and
customization of smart lighting

This device complies with Part 15 of the FCC Rules. Operation is subject to the following two conditions: (1) this device may not cause harmful interference, and (2) this device must accept any interference received, including interference that may cause undesired operation.

WARNING: Some products included in this specification sheet may be subject to the warning requirements of California's Proposition 65. Please refer to your product packaging for more information.

Amazon, Alexa and all related logos are trademarks of Amazon.com, Inc. and its affiliates. Siri is a registered trademark of Apple Inc. Google, Google Play and Google Home are trademarks of Google LLC.

SATCO.COM | 800-437-2826

© Satco Products, Inc. All rights reserved. Rev. 6/25 SN1640



ITEM SPECIFICATIONS/ORDERING INFO

Item	Finish	Chime Finish	Width (A)	Height (B)	Extends (C)	Weight
65-935	White	Black	2.09"	5.45"	1.19"	0.45 Lbs.
65-936	Black	Black	2.09"	5.45"	1.19"	0.45 Lbs.

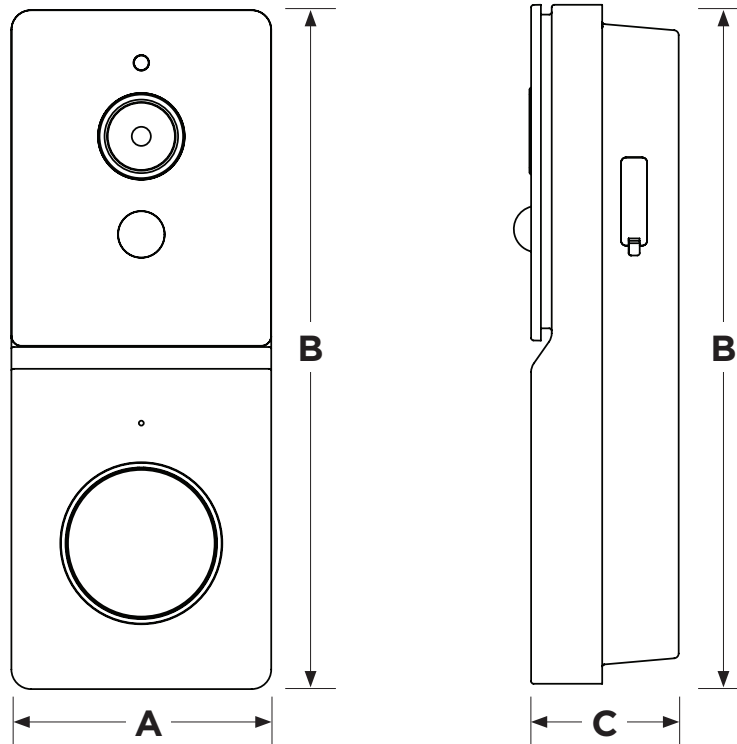

CHIMES (SOLD SEPARATELY)

Item	Chime Finish
86-935	White
86-936	Black