

LED DISK LIGHTS - WITH OCC SENSOR

7" & 10" | CCT SELECTABLE



7"



10"



5 CCT SELECTABLE

**ON/OFF OR 30% STEP DOWN
PIR SENSOR**

**90 CRI HIGH QUALITY
ILLUMINATION**

AVAILABLE IN 7" & 10" WHITE

SUGGESTED APPLICATIONS

Bathrooms
Kitchens
Bedrooms
Hallways
Multifamily
Hospitality



ColorQuick

Selectable Color Technology

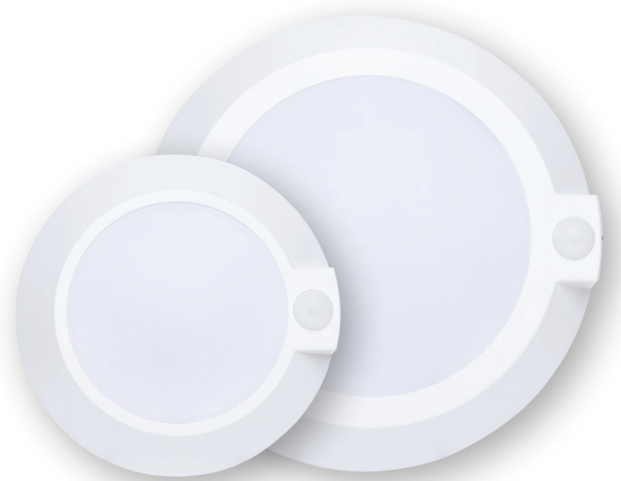
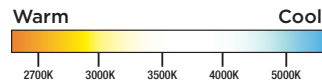

SATCO|NUVO's white CCT Selectable Disk Lights deliver efficiency, convenience, and modern performance in 7" and 10" sizes. With five selectable color temperatures (2700K/3000K/3500K/4000K/5000K), these fixtures adapt to a wide range of lighting needs. The integrated occupancy sensor supports energy savings and hands-free illumination for added safety. A color rendering index (CRI) of 90 ensures clean, accurate light quality. Designed with step-down dimming, 2.5kV surge protection, a 50,000-hour rated life, and a damp location rating, these disk lights provide long-lasting, reliable performance.



GENERAL SPECIFICATIONS

Input Voltage: 120V

Frequency: 60Hz

Power Factor: 0.9

Dimming: 30% Step Down with PIR Sensor

CRI: 90

CCT Selectable: 2700K/3000K/3500K/4000K/5000K

Surge Protection: 2.5kV

Beam Angle: 110°

Location Rating: Damp

Ambient Operating Temperature: -20°C (-4°F) to +40°C (+104°F)

Suitable for bathroom applications: Yes

Construction: Aluminum / Plastic

Finish: White

Lens Material: Polycarbonate

Functional Life: 50,000 Hours

Warranty: 5 Years



ITEM SPECIFICATIONS / ORDER INFO

Item	Size	Wattage	Incandescent Replacement Wattage	Lumens	Input Current	Efficacy
62-1820R1	7"	10.9W	60W	900	0.10A	Up to 82 LPW
62-1821R1	10"	12.6W	100W	1060	0.11A	Up to 84 LPW

DIMENSIONS / WEIGHTS

Item	Diameter (A)	Height (B)	Weight
62-1820R1	7.40"	1.56"	0.56 Lbs.
62-1821R1	9.80"	1.72"	0.95 Lbs.

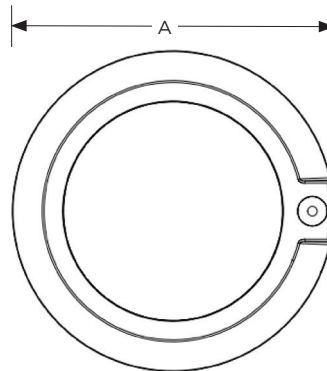

FEATURES



Integrated Occupancy Sensor



5 CCT Selectable Switch



Durable Steel Housing



White Polycarbonate Lens

This device complies with Part 15 of the FCC Rules. Operation is subject to the following two conditions: (1) this device may not cause harmful interference, and (2) this device must accept any interference received, including interference that may cause undesired operation.

WARNING: Some products included in this specification sheet may be subject to the warning requirements of California's Proposition 65. Please refer to your product packaging for more information.

Meets requirements of ICES-005 issue 5 class B for use in residential applications.

Fixture may not be compatible with all dimmers. See satco.com for details.

Replacement wattage shown depends on application and fixture.

Specifications are subject to change without prior notice.

Visit satco.com/service/warranty for complete warranty details.